

- Wear Resistant**

The guide rod and piston rod have an advanced surface treatment, which combined with self-lubricating bearings, provides superior wear resistance and extends the life of all sliding components.

- Watertight Protection**

O-Rings are all fitted bodies, caps and joints to prevent water ingress.

- ISO Valve Mounting**

The Series SF actuators valve interface meets ISO standards, and meets the dimensional requirements of ISO defined for each torque range.

- Corrosion Resistant**

The Series SF actuators incorporate over three stages of internal and external coatings to resist severe weather, chemical and petroleum environments.

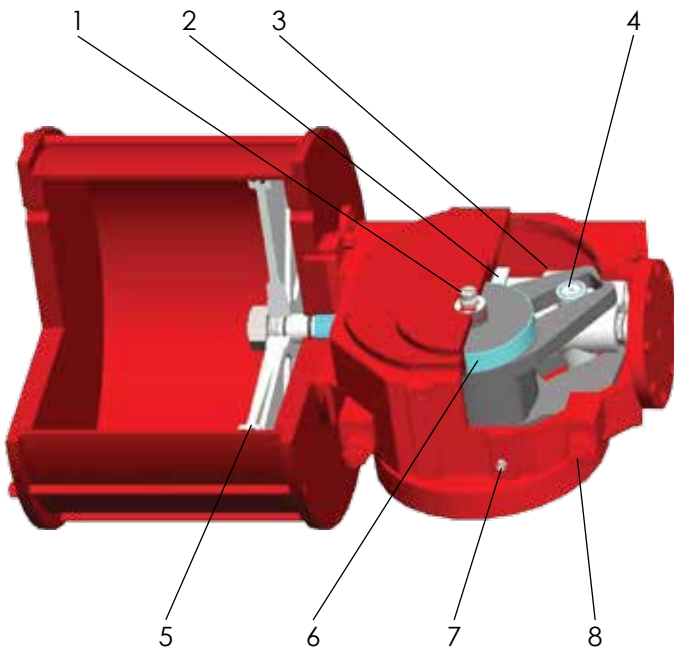

### DESIGN FEATURES

1. NUMAR accessory mount.
2. PTFE guide bar. Prevents yoke pin axial movement, transferring axial loads directly to the drive module case.
3. Thrust Bearing. Connects the piston rod with the guide block, compensating for side load deflection and reducing wear on the rod, bearings and seals.
4. Roller. Reduce the friction between the yoke arm and pin, minimizing the wear of the yoke arm and pin.
5. PTFE guide ring. Prevents metal to metal contact with the cylinder bore.
6. Replaceable Bearings. Protect sliding and rotating components, with suitability for either dry or lubricated working conditions.
7. Integral Housing Vent. The main actuator housing incorporates an integral check valve in order to release overpressure.
8. 80°~100° Travel Stops. Bi-directional travel stops that allow for 80°-100° total travel adjustment, preventing ingress of foreign objects or water.

Model	Maximum Design Torque	Air Pressure Recommended 60-80 PSI (Max 90 PSI)							
		43.5 PSI - 3 BAR		58 PSI - 4 BAR		72.5 PSI - 5 BAR		87 PSI - 6 BAR	
		Break	Run	Break	Run	Break	Run	Break	Run
SF25-350DA	5900	2895	1756	3861	2341	4825	2927	5791	3513
SF30-450DA	11800	5686	3449	7582	4599	9278	5628	11373	6899
SF30-550DA		8495	5154	11327	6871	-	-	-	-

All torque values are in ft-lbs.

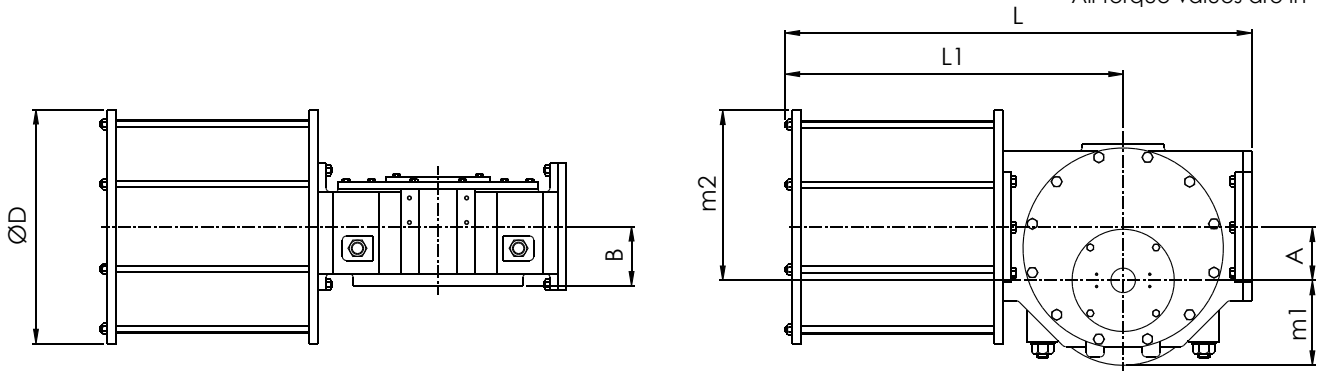

Model	A	B	ØD	m1	m2	L	L1	ISO Mount	Air Inlet
SF25-350DA	90	104	415	150	292.5	776	556	F25	½"
SF30-450DA	110	130	520	175	370	922	662	F30	¾"
SF30-550DA			620		420				

All dimensions are in mm