



FEATURES

- TWO PIECE BALL VALVE
- ANSI B 1.20.1 NPT THREADS
- FULL BORE BALLS
- 1000 WOG
- BLOW OUT PROOF STEM
- ADJUSTABLE STEM PACKING
- LOW OPERATING TORQUE
- QUICK LOCK HANDLE

MATERIALS LIST

NO.	PART NAME	MATERIAL	QTY
1	BODY	A351-CF8M	1
2	END CAP	A351-CF8M	1
3	BALL	A351-CF8M	1
4	STEM	SS316	1
5	SEAT	RPTFE	2
6	THRUST WASHER	PTFE	1 SET
7	STEM PACKING	PTFE	1
8	GLAND NUT	SS304	1
9	SPRING WASHER	SS304	1
10	NUT	SS304	1
11	HANDLE	SS304	1
12	LOCKING PAD	SS304	1
13	HANDLE COVER	PLASTIC	1
14	GASKET	PTFE	1

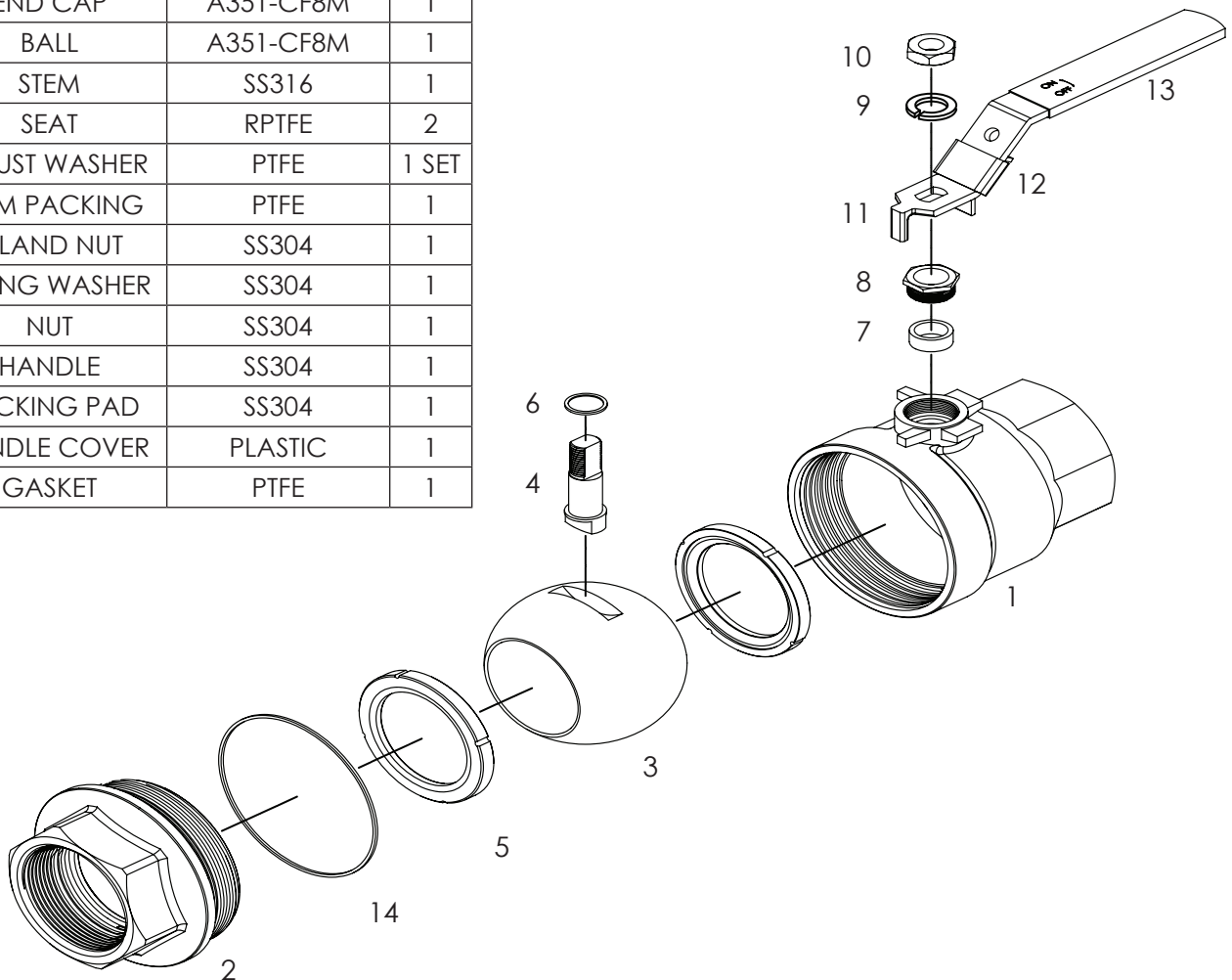

SERIES 8000 2-PIECE BALL VALVE

www.valvesolutions.com



SERIES 8000 BALL VALVE

PRESSURE AND TEMPERATURE RATINGS

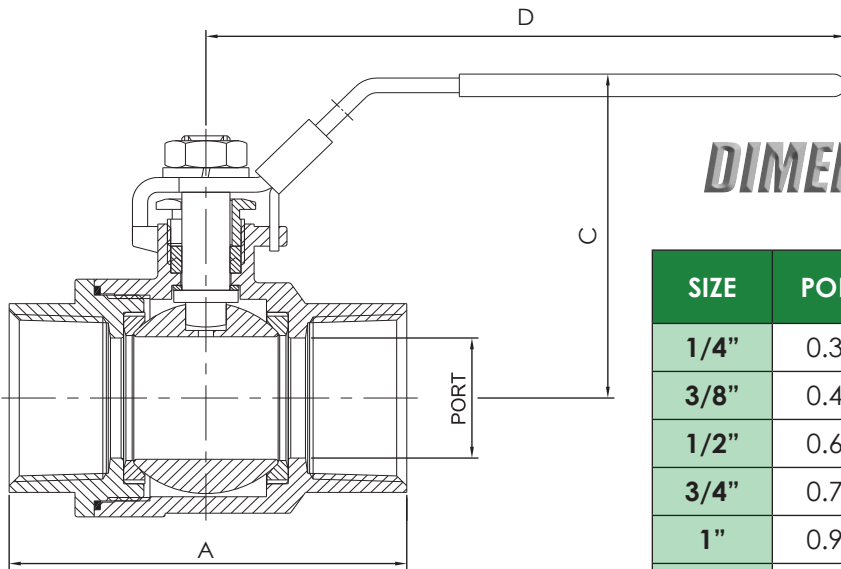
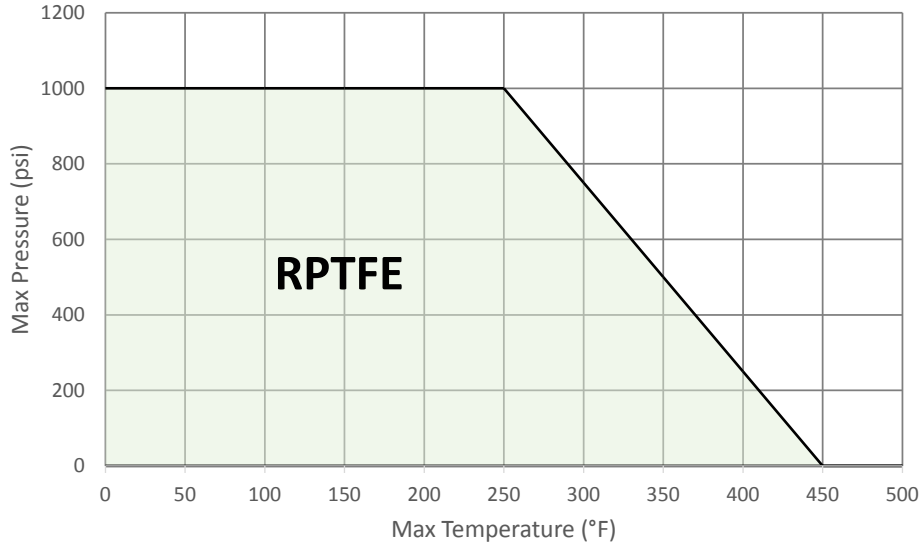

DIMENSIONS AND WEIGHTS

SIZE	PORT	A	C	D	WEIGHT (lb)
1/4"	0.39	1.93	1.71	3.23	0.35
3/8"	0.49	1.93	1.71	3.23	0.35
1/2"	0.63	2.31	1.89	3.23	0.53
3/4"	0.79	2.70	2.25	4.02	0.84
1"	0.96	3.09	2.65	5.00	1.41
1 1/4"	1.26	3.67	2.90	5.00	2.16
1 1/2"	1.50	4.06	3.33	6.38	3.48
2"	1.97	4.84	3.64	6.38	5.86

VALVE PART NUMBERS

1" S8000-S2H

VALVE SIZE

S-STAINLESS

SERIES 8000 2-PIECE BALL VALVE